

# FETTEC 2004-1800KV

## Technical Datas

<b>KV</b>	<b>1800</b>
<b>Configu-ration</b>	<b>12N14P</b>
<b>Stator Diamter</b>	<b>20mm</b>
<b>Stator Length</b>	<b>4mm</b>
<b>Shaft Diameter</b>	<b>3mm(in) 1.5mm(out)</b>
<b>Motor Dimension(Dia.*Len)</b>	<b>Φ 25*13.7mm</b>
<b>Weight(g)</b>	<b>15.5 (3cm Wire)</b>
<b>Idle current(10)@10V(A)</b>	<b>0.55</b>
<b>No.of Cells(Lipo)</b>	<b>4~6S</b>
<b>Max Continuous Power(W)5S</b>	<b>330</b>
<b>Internal Resistance</b>	<b>220mΩ</b>
<b>Max Current(5S)</b>	<b>13A</b>
<b>Max.Efficiency Current</b>	<b>(0.6-2A)&gt;84%</b>

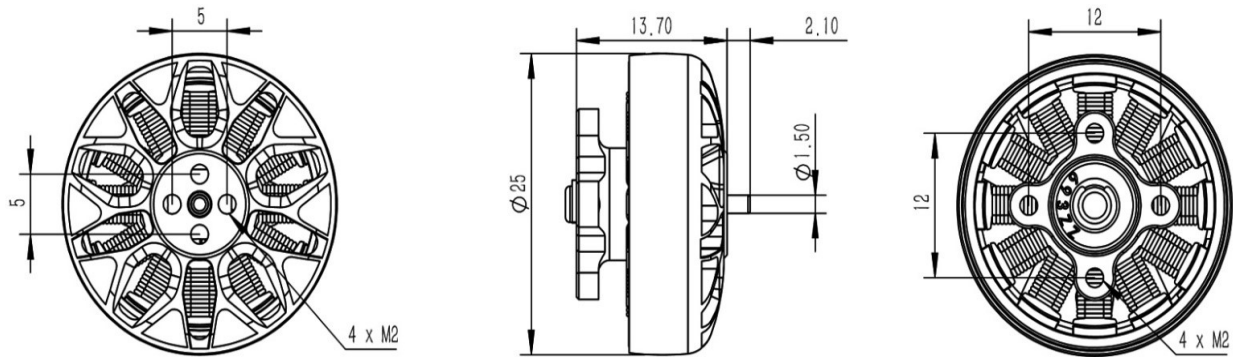

Prop (inch)	Voltages (V)	Throttle (%)	Load Currency (A)	Pull(g)	Power(W)	Efficiency(g/W)	Temperature(in full throttle load 5's)
GF4024R	21	50%	0.9	141	18.9	7.460	45°C
		100%	4.8	486	100.8	4.821	
	25.2	50%	1.3	205	32.8	6.258	50°C
		100%	6.7	682	168.8	4.039	
HQT5*3R	21	50%	1.8	286	37.8	7.566	57°C
		100%	9.4	866	197.4	4.387	
	25.2	50%	2.7	423	68.0	6.217	69°C
		100%	12.1	1076	304.9	3.529	
HQT5*2*3R	21	50%	1.7	237	35.7	6.639	54°C
		100%	8.6	801	180.6	4.435	
	25.2	50%	2.4	356	60.5	5.886	65°C
		100%	11.3	1033	284.8	3.628	
GF5125R	21	50%	2	320	42.0	7.619	63°C
		100%	10.2	921	214.2	4.300	
	25.2	50%	2.6	418	65.5	6.380	72°C
		100%	12.7	1127	320.0	3.521	